

# Quick Assembly Guide

## BESV PSF1



# Contents

<b>1.</b>	<b>Introduction to the Spare Parts.....</b>	<b>2</b>
1.1	BESV PSF1.....	2
1.2	Accessory package and spare parts.....	2
<b>2.</b>	<b>Assembly Process.....</b>	<b>3</b>
2.1	Install Your Front Wheel.....	3
2.2	Install the Seat Tube of the Cushion and Unfold the Bike.....	5
2.3	Install the Pedals.....	7
2.4	Install Battery.....	8
2.5	Install the Rear Reflector (Japanese Version).....	9
2.6	Install the Reflector on Wheel (The colour varies by countries).....	10
2.7	Install the Headlamp (Taiwanese/South Korean Version).....	12
2.8	Install the Headlamp (Chinese Version).....	13
2.9	Install the Rear Light and License Plate Rack (Chinese Version).....	14
2.10	Install the Front Fender (selective assembly).....	17
2.11	Install the Rear Fender (selective assembly).....	20
2.12	Install the Rear Carrier (selective assembly).....	23
2.13	Install Rear Fender and Carrier (selective assembly).....	26
<b>3.</b>	<b>Check.....</b>	<b>30</b>

## Introduction to the Spare Parts

### 1.1 BESV PSF1



### 1.2 Accessory package and spare parts

The package contains the following spare parts:

1. Reflector on wheel\*2
2. Rear reflector (including bracket) \*1 [For the Japanese version only]
3. Charging adapter\*1
4. Charging Cable\*1
5. headlamp\*1 [For the Taiwanese/Chinese/Korean version only]
6. components of headlamp (Headlamp locking screws, the washer and spring washer)
7. Folding pedal\*1
8. Rubber gasket on the front of the suspension \*2
9. Transparent protection sticker for front fork \*2
10. Guarantee card \*1
11. Quick release for front wheel\*1
12. Warranty card\*1
13. Various User manuals
14. Warranty\*1

## 2. Assembly Process

### 2.1 Install Your Front Wheel

2.1.1 Pull out your bike and the front wheel.



2.1.2 Insert the front wheel into the hook jaw of front fork.



The disk needs to be stuck in the center of calliper.



### 2.1.3 Install the quick release

Unscrew the nut of quick release and install it from the left side of the bike. The spring should be smaller on the inner side and larger on the outside.

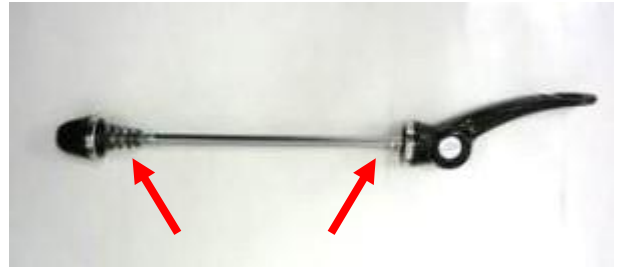

Note: the handle of quick release is on the right side of bike

### 2.1.4 Screw the nut of quick release

Tighten the nut first, then loosen about 1/4 turn.



Press the handle of quick release upward and parallel it with front fork.

Rotate the front wheel, make sure the rotation is smooth and complete the installation of front wheel.

## 2.2 Install the Seat Tube of the Cushion and Unfold the Bike

Take out the seat tube of the cushion from box and install it on the bike.



### 2.2.1 Unfold the vertical pipe

Unfold and put the vertical pipe upright, and fasten the safe lock.



### 2.2.2 Unfold the rear wheel

Open the pull pin outward, lift the bike and spread the rear wheel backward to make sure the back suspension is buckled on the suspension pull pin.



Complete the assembly of bike.



## 2.3 Install the Pedals

2.3.1 Pull out the pedals from the accessory package.

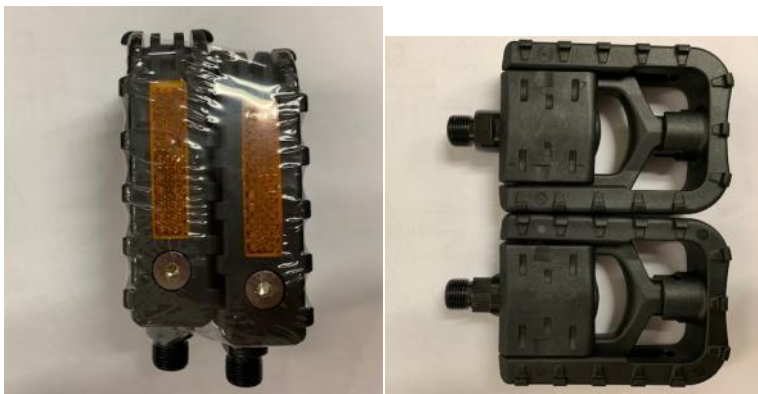

2.3.2 Install the right pedal.

\*Note: the 'R' on the axis of a pedal means it is the right pedal. Rotate the pedal with R clockwise, install it into the axle hole of the right crank and lock it up.



2.3.3 Install the left pedal.

Rotate the other pedal counterclockwise, install it into the axle hole of the left crank and lock it up. Note: it needs to be rotated counterclockwise for installation.



Complete pedals assembly.



## 2.4 Install battery

2.4.1 Turn the key to “OPEN”



2.4.2 Align the metal slot on the frame and push the battery to the end.



2.4.3 Press the key and turn it to “OFF”. lock up the battery and assemble it.



## 2.5 Install the Rear Reflector (Japanese Version)

### 2.5.1

The spare parts of the reflector

Rear reflector\*1

Reflector bracket\*1

M5 screw\*2

M5 nut \*1

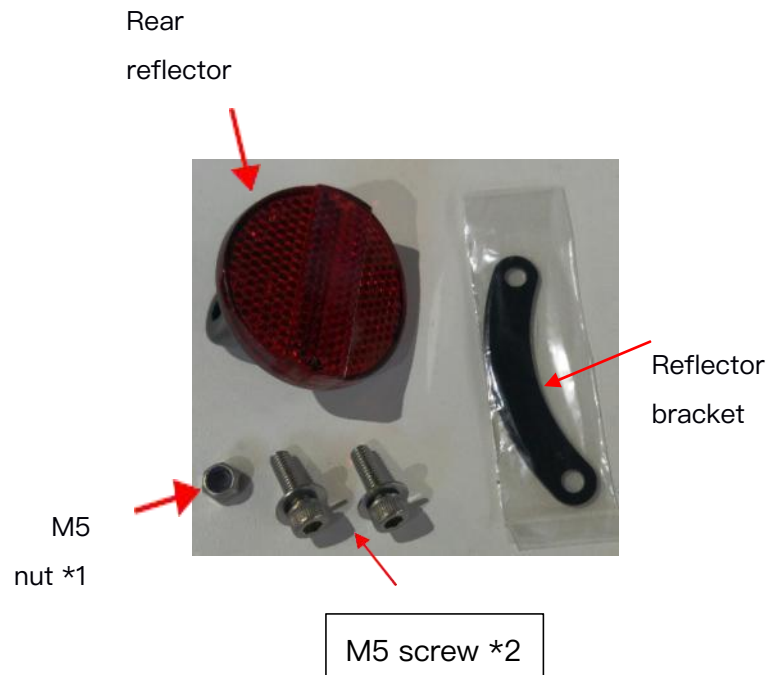

2.5.2 Fixate the reflector bracket onto the nut on left rear fork of the frame.

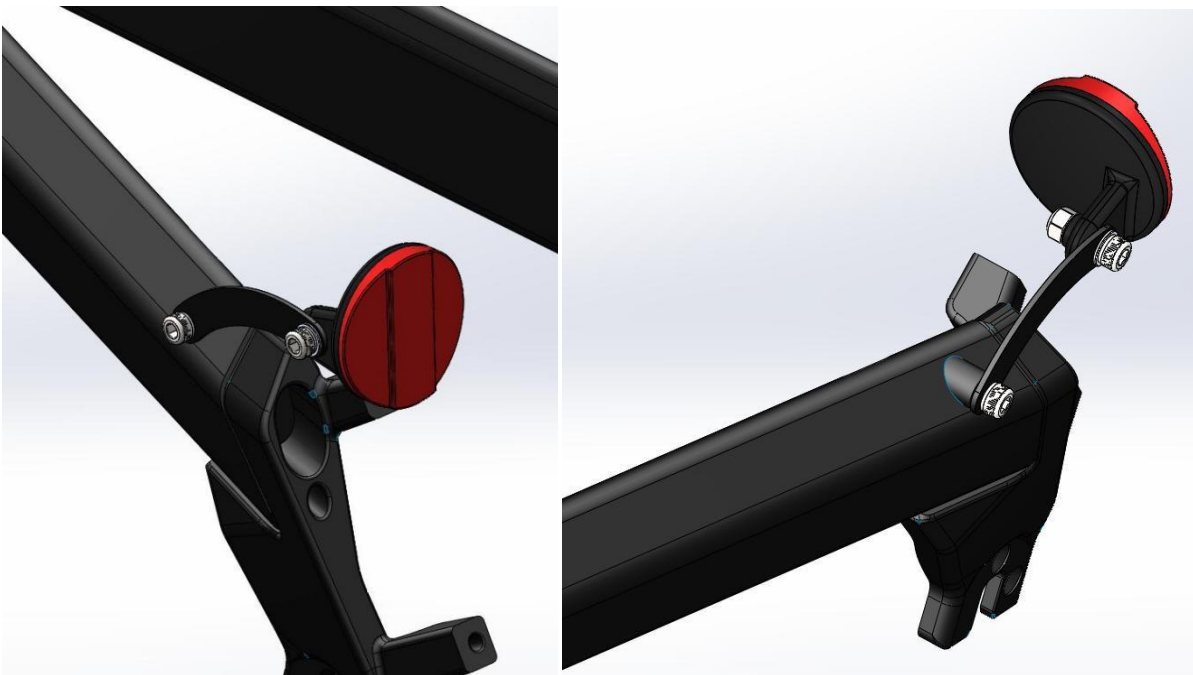

2.5.3 Place the reflector on the inside, and fixate the screw from the outside onto the inside with the nut.

## 2.6 Install reflector on wheel

(The colour varies by country.)

2.6.1 The position of assembly: the left side of the wheel. Opposite to the air nozzle.

Choose a straight bar for assembly.

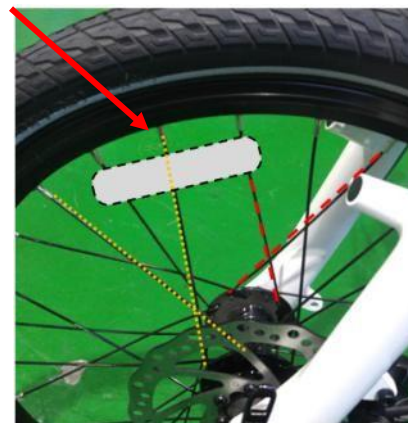

2.6.2 Use one left and two right spokes to jam the reflector and push it to the outside of the wheel as much as possible.



2.6.3 Wrap the plastic screw, tighten it and complete assembly.



2.6.4 The same procedure applies to the rear wheel



2.6.5 Complete the reflectors on wheels part.



## 2.7 Install the Headlamp (Taiwanese/South Korean Version)

2.7.1 Position: M6 screw hole at the top of the front fork.



2.7.2 After headlamp is installed on the bracket, lock it into the keyhole of front fork with M6 screw/washer/spring washer in the accessory package.



## 2.8 Install the Headlamp (Chinese Version)

No.	Note
1	Headlamp
2	Headlamp locking screws M6 12L
3	Headlamp flat washer
4	Headlamp spring washer



Insert the nut into the front fork according to the figure.

## 2.9 Install the Rear Light and License Plate Rack (Chinese Version)

No.	Note
1	plastic frame of the licence
2	metal frame of the licence
3	rear light



2.9.1 Combine the metal with the plastic frame as shown in the below pictures. Then, lock the two screws and gaskets with nut on the back (do not drop the nut in the process).



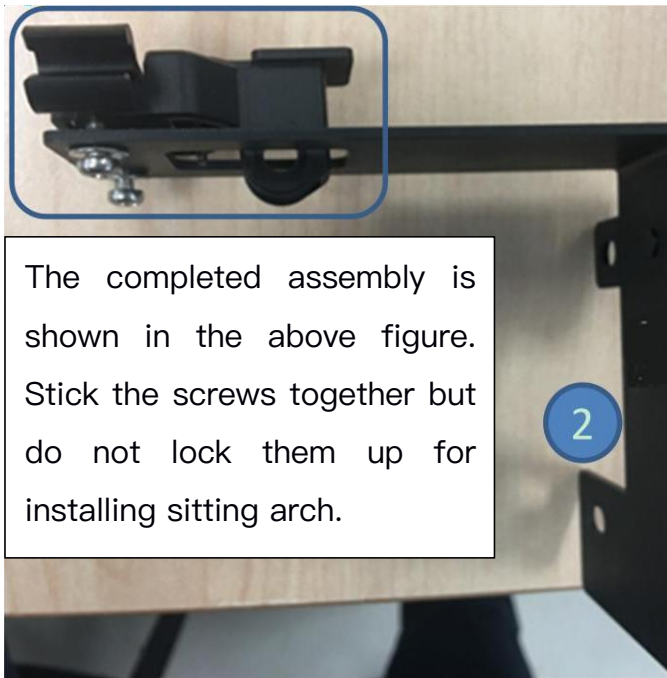

2.9.2 Place rear lamp and the metal bracket hole in central positions and lock.





2.9.3 Insert the plastic bracket groove into seat bow. Adjust the position towards the back and lock the screws. If there is not enough, adjust the seat position.

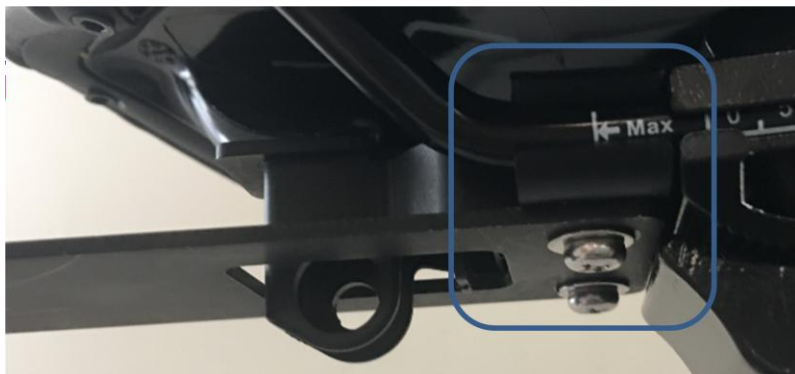

2.9.4 Completion is shown as follows.



## 2.10 Install the front fender (selective assembly)

ITEM	PART NO.	DESCRIPTION	Qty.	NOTE
1	34.Y93FN.001	FENDER FRONT SW-FA-513-50 FIXED 50MM WIDTH FOR 20 INCH,W/STAY*1, W/DIP COATING, W/TAIL 803F, YTRT10	1	PSF1前土除
2	8F.7RA3A.120	SCREW CAP HEAD INTER HEX STAINLESS M6*L12	1	M6短螺絲
3	8H.22201.A15	WASHER SPRING STAINLESS M6*T1.5	1	M6彈簧華司
4	8H.12301.A10	WASHER FLAT STAINLESS M6*16*T1.0	1	M6 華司OD=16
5	8F.6RY38.100	SCREW MACH ROUND INTER HEX SUS STEEL B-ZN FI M5 10 MM	2	M5*10L螺絲
6	8H.12201.810	WASHER STD SUS M5*T1.0	2	M5華司



### 2.10.1 Remove the protection sticker off the left front fork.

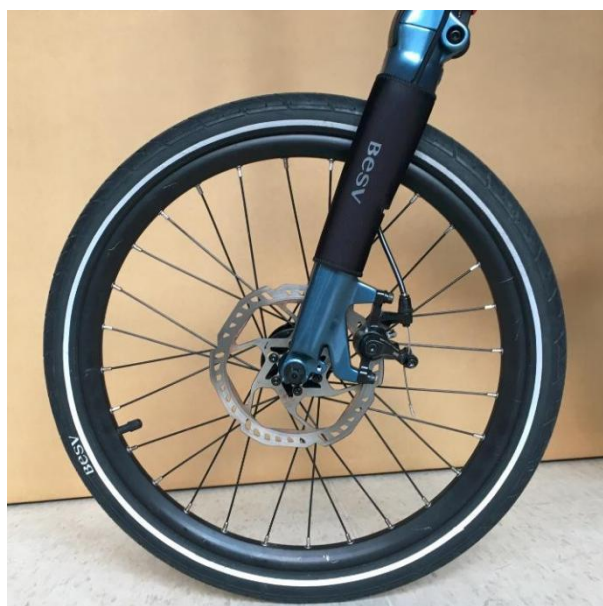

2.10.2 Install the fender onto the fender (pay attention to direction of installation). Please refer to the exploded-view drawing. The torsion force of locking is 3Nm.



2.10.3 Install the hanger into the eyelet behind the front fork. The orders of spare parts are shown in the exploded-view drawing. The torsion force of locking is 3Nm (do not lock up the screw. Just insert it).



2.10.4 Install the left and right fenders in the inner side of front wishbone. The orders of spare parts are shown in the exploded-view drawing. The torsion force of locking is 5Nm (do not lock up the screw. Just insert it).



2.10.5 Adjust the fender properly, lock the screw up with torsion, wrap the protection pack on the front fork and complete the assembly of front fender.



## 2.11 Install the rear fender (selective assembly)

ITEM	PART NO.	DESCRIPTION	Qty.	NOTE
1	47.Y93RP.014	RUBBER PART FOR PSF1 REAR FENDER, BK, YTRT10	1	PSF1 後土除輪座塑膠件
2	47.Y93RP.010	RUBBER PART JA5038 SINGLE WHEEL FOR MUDGUARD OD40MM, BK, YTRT10	2	PSF1後土除輪
3	8H.34201.014	WASHER WS12-64-1.4 PA M6*T1.4, BLACK	2	黑色尼龍墊片1.4MM
4	8F.00005.330	SCREW TRUSS HEAD STAINLESS INNER HEX M5*L33 NYLOK+3, YTRT10	2	PSF1後土除輪螺絲
5	8F.6RY38.100	SCREW MACH ROUND INTER HEX SUS STEEL B-ZN F1 M5 10 MM	2	PSF1 後土除輪座塑膠件螺絲
6	8G.62103.850	NUT LOCK SUS FINE THREAD M5*H5.0	2	PSF1 後土除輪座塑膠件螺帽
7	8F.6RA38.120	SCREW MACH ROUND HEAD INTER HEX SUS M5*12L	1	M5*12L螺絲
8	8H.12201.810	WASHER STD SUS M5*T1.0	1	M5華司
9	8H.22201.812	WASHER SPRING STAINLESS M5*T1.2	1	M5彈簧華司
10	8F.7QA68.150	SCREW MACH CAP IN HEX FLAT+SPRING SUS STEEL NYLOK+3 M5 15 MM FENDER REAR SW-FA-513-50 FIXED 50MM WIDTH FOR 20 INCH,W/STAY*2, YTRT10	2	M5*15L螺絲合墊片
11	34.Y93FN.002		1	PSF1後土除

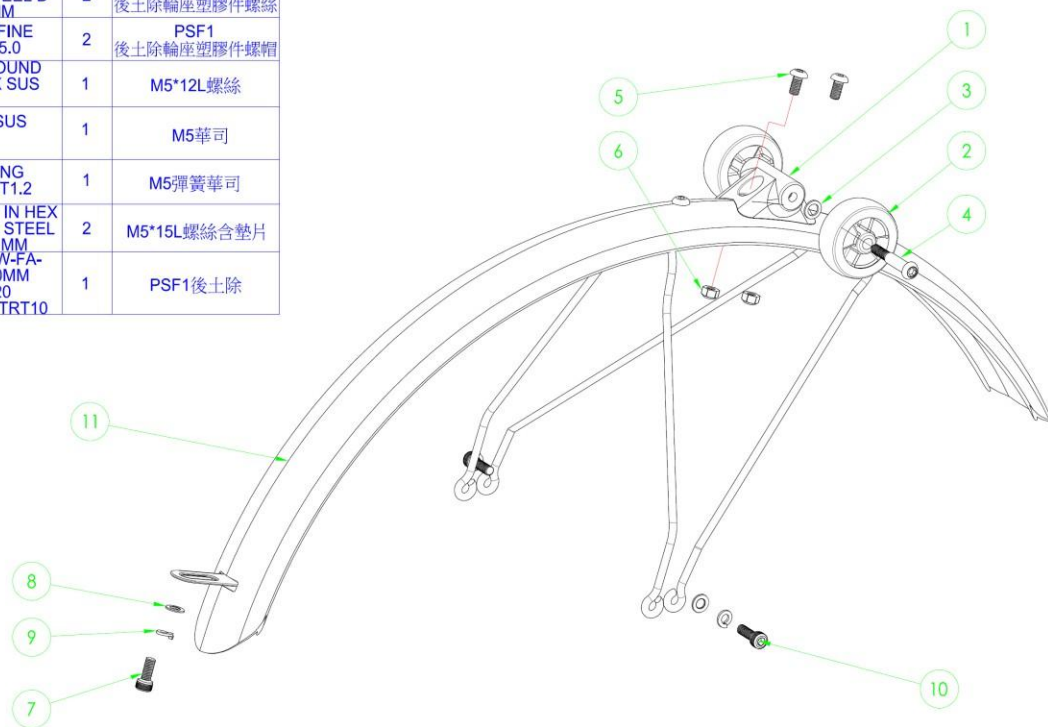

2.11.1 Install the front and rear wheels onto the fender (mind the directions of installing, as is shown in the following). The orders of spare parts are shown in the exploded-view drawing. The torsion force of locking is 3Nm.



2.11.2 Install the hanger of front fender into the M5 eyelet under the rear fork. The orders of spare parts are shown in the exploded-view drawing. The torsion force of locking is 5Nm (do not lock up the screw. Just insert it).



2.11.3 Install the fender onto the left and right attachment near the rear fork. The orders of spare parts are shown in the exploded-view drawing. The torsion force of locking is 5Nm (do not lock up the screw. Just insert it)



2.11.4 Properly adjust the fender, lock the screw up with torsion, and complete the assembly, as is shown in the following figure.



## 2.12 Install the rear carrier (selective assembly)

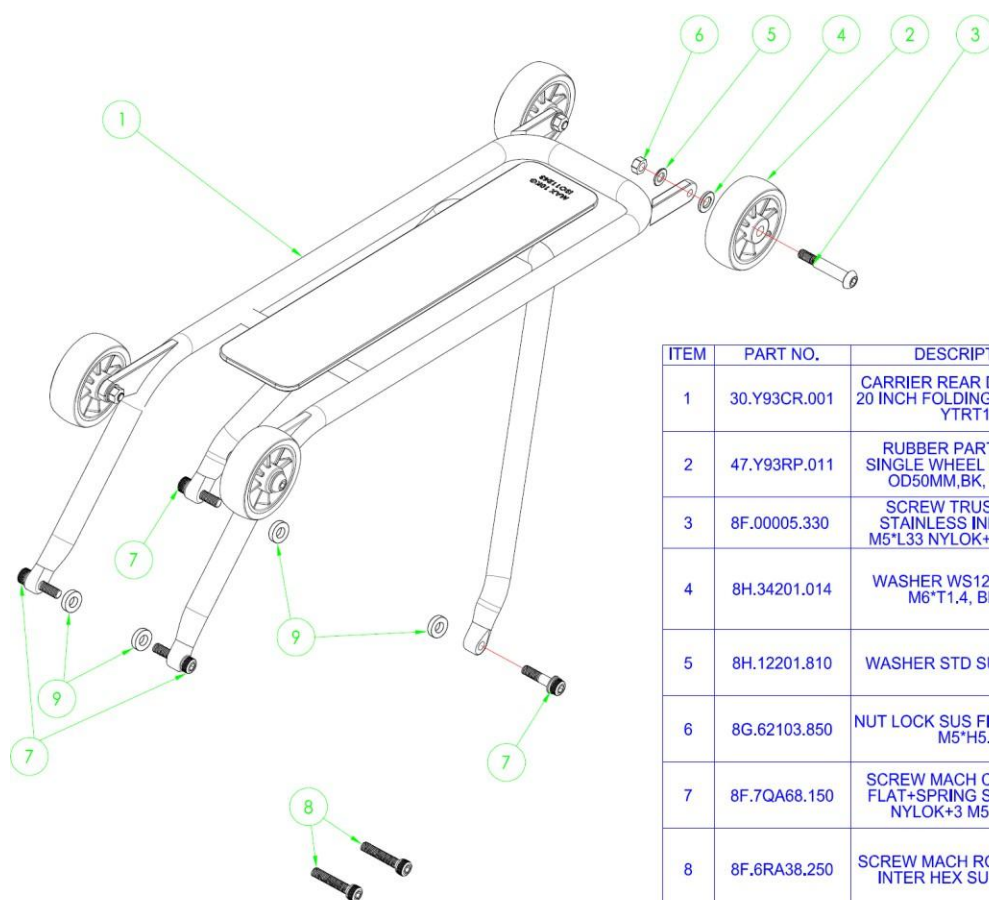

ITEM	PART NO.	DESCRIPTION	Qty.	NOTE
1	30.Y93CR.001	CARRIER REAR DF-002 FOR 20 INCH FOLDING, BLACK AL, YTRT10	1	PSF1後貨架
2	47.Y93RP.011	RUBBER PART JA5035 SINGLE WHEEL FOR RACK OD50MM,BK, YTRT10	4	PSF1後貨架輪
3	8F.00005.330	SCREW TRUSS HEAD STAINLESS INNER HEX M5*L33 NYLOK+3, YTRT10	4	PSF1後貨架輪螺絲
4	8H.34201.014	WASHER WS12-64-1.4 PA M6*T1.4, BLACK	4	黑色尼龍墊片1.4MM
5	8H.12201.810	WASHER STD SUS M5*T1.0	4	M5*T1.0華司
6	8G.62103.850	NUT LOCK SUS FINE THREAD M5*H5.0	4	M5螺帽
7	8F.7QA68.150	SCREW MACH CAP IN HEX FLAT+SPRING SUS STEEL NYLOK+3 M5 15 MM	4	M5*15L螺絲含墊片(無土除時選用此4顆短螺絲)
8	8F.6RA38.250	SCREW MACH ROUND HEAD INTER HEX SUS M5*25L	2	M5*25L含墊片螺絲(同時組裝後土除及後貨架時，後面兩個鎖點使用此長螺絲)
9		SPACER T=2MM BLACK	4	後貨架附的4顆黑色鋁墊片

2.12.1 Remove the foldable bracket off (Properly keep the removed bracket. If the carrier is not installed, the bracket should be assembled for folding and standing).





2.12.2 The four wheels of the carrier, spare parts and detailed components are shown in the exploded-view drawing.



\*The force of screw locking torque is 3Nm

2.12.1 Front and rear screws on the left of lock, spare parts and detailed components are shown in the exploded-view drawing.

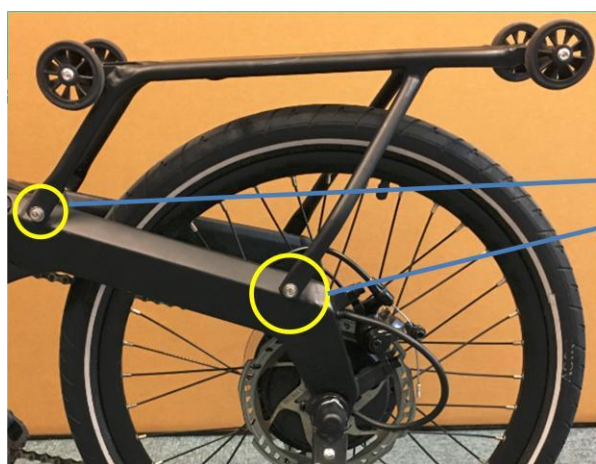

Washers should be added inside the racket

2.12.2 Front and rear screws on the left of lock, spare parts and detailed description of components are shown in the exploded-view drawing



Washers should be added inside the racket

2.12.3 Lock the four screws with 5Nm of torque force to complete the assembly of carrier.



## 2.13 Install rear fender and rear carrier (selective assembly)

ITEM	PART NO.	DESCRIPTION	Qty.	NOTE
1	8F.6RY38.100	SCREW MACH ROUND INTER HEX SUS STEEL B-ZN FILM 5.10MM	2	PSF1 後土除輪座膠膠件螺絲 後土除輪座膠膠件螺絲
2	8G.62103.850	NUT LOCK SUS FINE THREAD M5*15.0	6	PSF1 後土除輪座膠膠件螺絲 後土除輪座膠膠件螺絲
3	8F.6RA38.120	SCREW MACH ROUND HEAD INTER HEX SUS M5*12L	1	M5*12L螺絲
4	8H.22201.812	WASHER SPRING STAINLESS M5*T1.2	3	M5彈簧華司
5	8H.12201.810	WASHER STD SUS M5*T1.0	7	M5華司
6	34.Y93FN.002	FENDER REAR SW-FA-513-50 FIXED 50MM WIDTH FOR 20 INCH W/STAY*2, YTRT10	1	PSF1後土除
7	8F.6RA38.250	SCREW MACH ROUND HEAD INTER HEX SUS M5*25L	2	M5*25L內墊片螺絲(後土除及後貨架即時組裝時，後方高壓膠線膠用此螺絲)
8	8F.7QA68.150	SCREW MACH CAP IN HEX FLAT+SPRING SUS STEEL NYLOK+3 M5 15 MM	2	銷貨架前方2顆短螺絲
9	30.Y93CR.001	CARRIER REAR DF-002 FOR 20 INCH FOLDING, BLACK AL YTRT10	1	PSF1後貨架
10	47.Y93RP.011	RUBBER PART JA5035 SINGLE WHEEL FOR RACK OD50MM.BK. YTRT10	4	PSF1後貨架輪
11	8F.00005.330	SCREW TRUSS HEAD STAINLESS INNER HEX M5*1.33 NYLOK*3, YTRT10	4	PSF1後貨架輪螺絲
12	8H.34201.014	WASHER WS12-64-1.4 PA M6*T1.4, BLACK	4	黑色尼龍墊片1.4MM
13		M5 SCREW & NUT	2	土除翻原本附的M5螺絲及螺帽

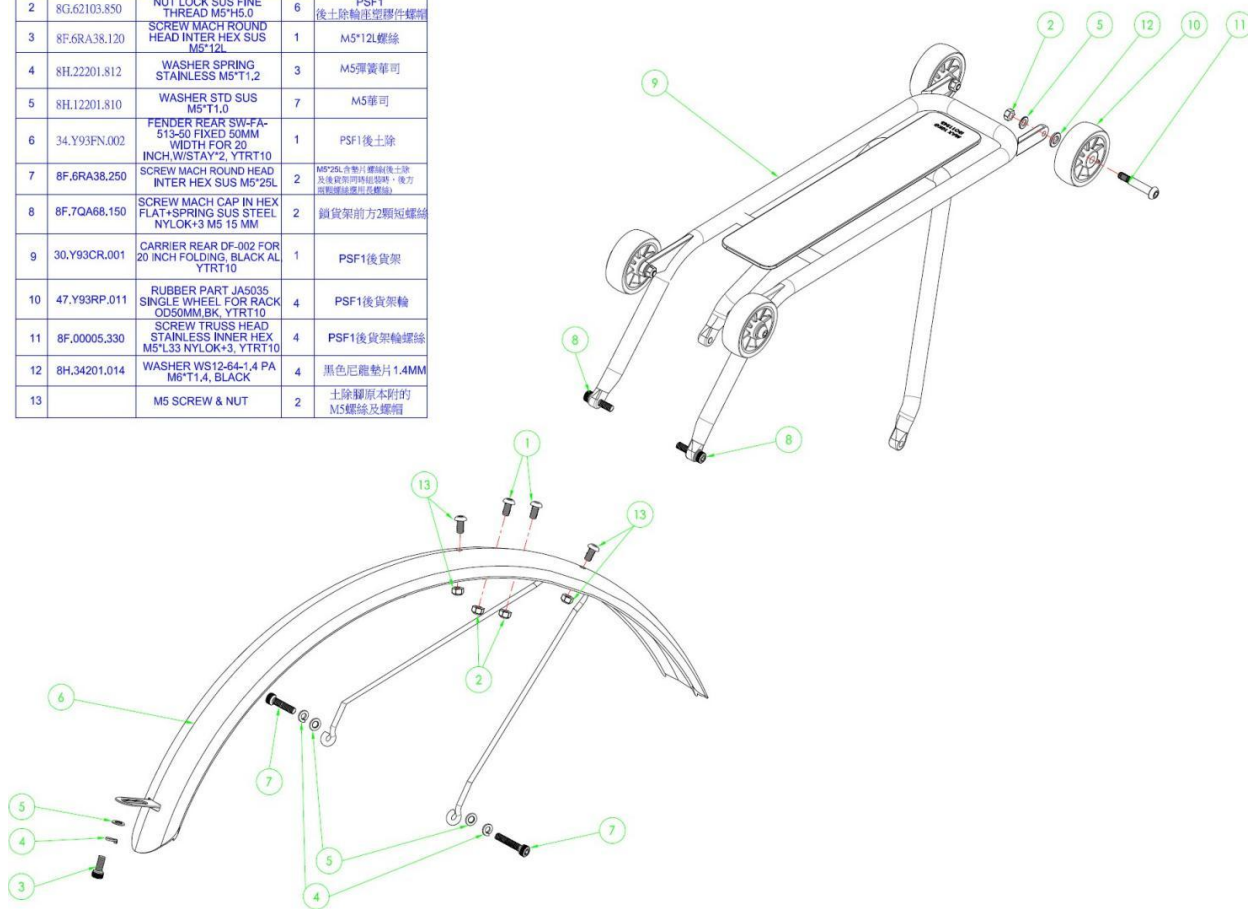

2.13.1 Install the rear fender (note the direction of installation in the following figure), original wheels, front fixed orifices, screws and nuts and orders of other spare parts are shown in the exploded-view drawing. The force of torque is 3Nm.



2.13.2 Install the hanger of front fender into the M5 eyelet under the rear fork. The orders of spare parts are shown in the exploded-view drawing. The torsion force of locking is 5Nm (do not lock up the screw. Just insert it)

2.13.3 Lock the left and right front bracket of the carrier onto the lower fork. The orders of spare parts are shown in the exploded-view drawing. The torsion force of locking is 5Nm (do not lock up the screw. Just insert it).



2.13.4 Install the left, right and back bracket of the carrier and fender onto the lower fork. The orders of spare parts are shown in the exploded-view drawing. The torsion force of locking is 5Nm (do not lock up the screw. Just insert it)



2.13.5 The rear fender and carrier are assembled and the fender is finely adjusted, shown in the following figure. The device is tightly screwed with torsion force to complete the assembly process.



### 3 Check

- 3.1 Check whether the tire pressure is normal.
- 3.2 Check whether the brake, transmission and chain work smoothly
- 3.3 Activate electric control to check whether the functions and power are normal. Refer to the PSF1 User Manual.
- 3.4 Check whether the function of folding is normal or not. Refer to the user manual for specific procedures of holding.

BESV PSF1 assembly accomplished.

